

SEC 35 T14N R4W

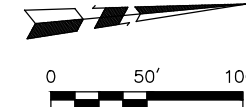

STA. 1092+88.00 CONST.
12' ASPH. SPECIAL RURAL
DRIVE LT. W18" RCP S.D.

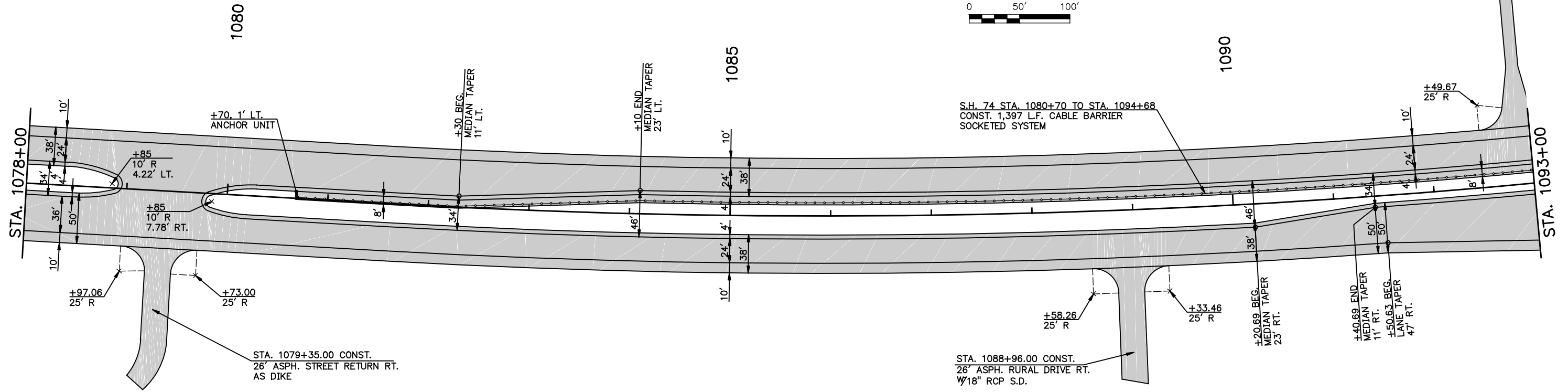

SEC 35 T14N R4W

SEC 26 T14N R4W

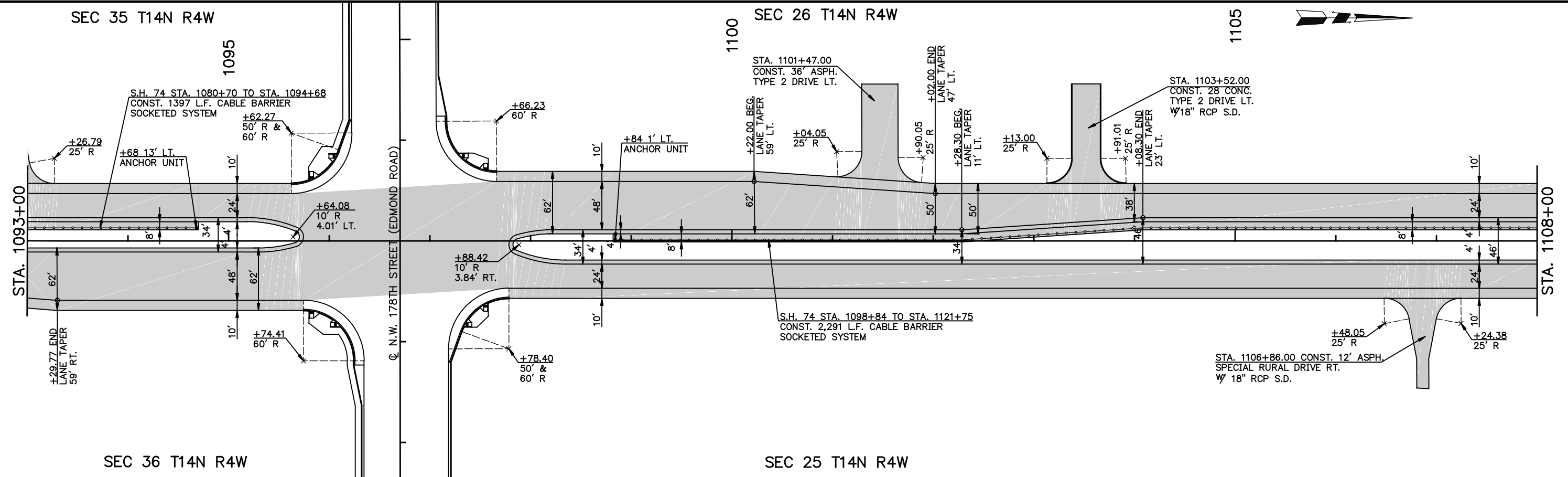

**SURFACING CONSTRUCTION DETAILS
AND CABLE BARRIER LAYOUT
S.H. 74 STA. 1078+00 TO 1108+00**